

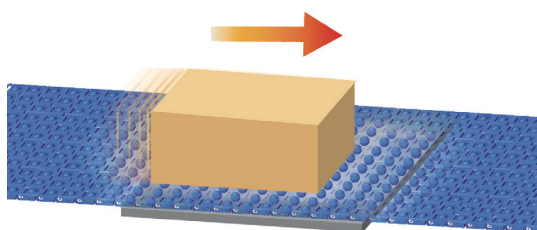

SYSTEM PLAST®

2253RTC

萬向滾珠模組網帶



輸送物以主網帶的2倍速度前進

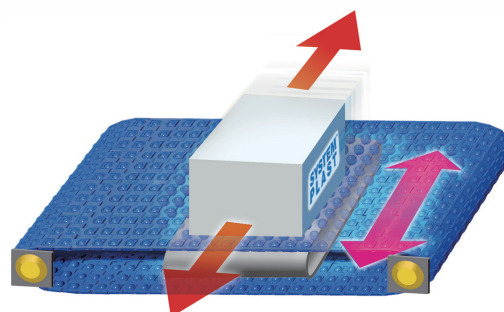

將輸送物橫向排出

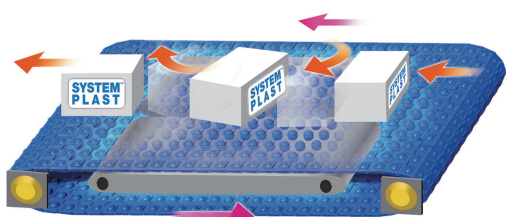

行進時旋轉

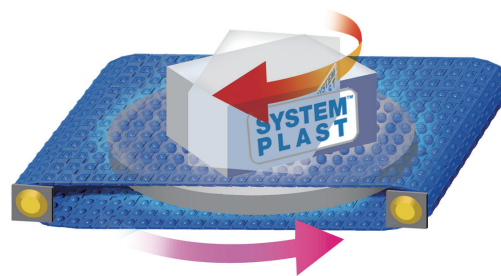

網帶上做原地旋轉至任一角度

行進間橫向排出

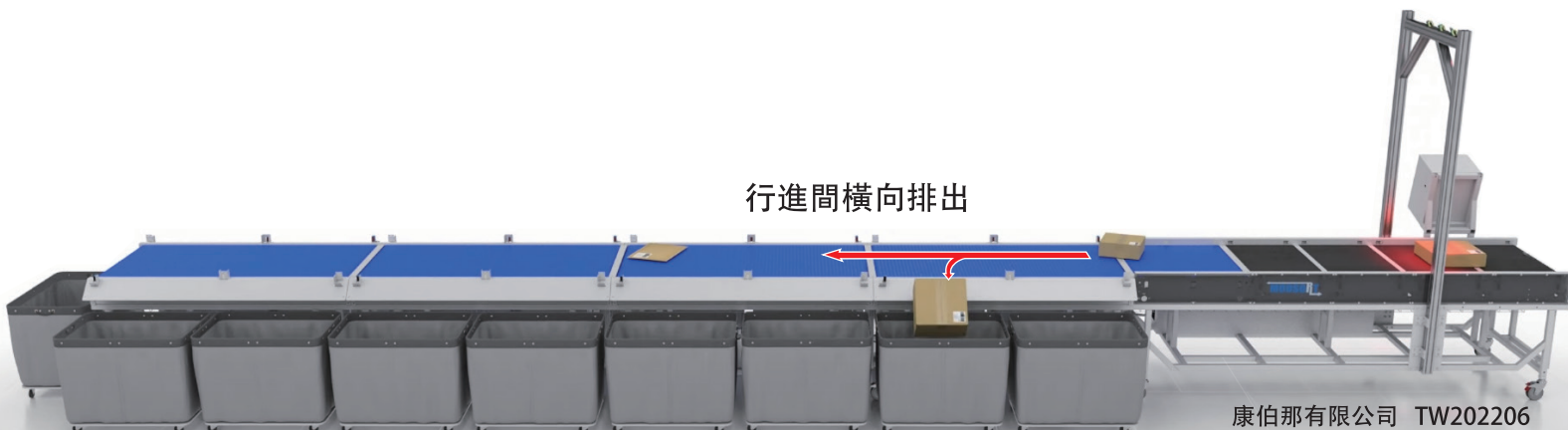

背彎半徑：40mm(1.58 in)
 最大荷重：10500 N/m(714 lbs/ft.)
 滾珠荷重：10 N(1kg)(2.24 lbs)
 重量：10.5 kg/m² (2.14 lbs/ft²)
 滾珠材質：聚醯胺(尼龍)
 標準PIN材質：白色PBT

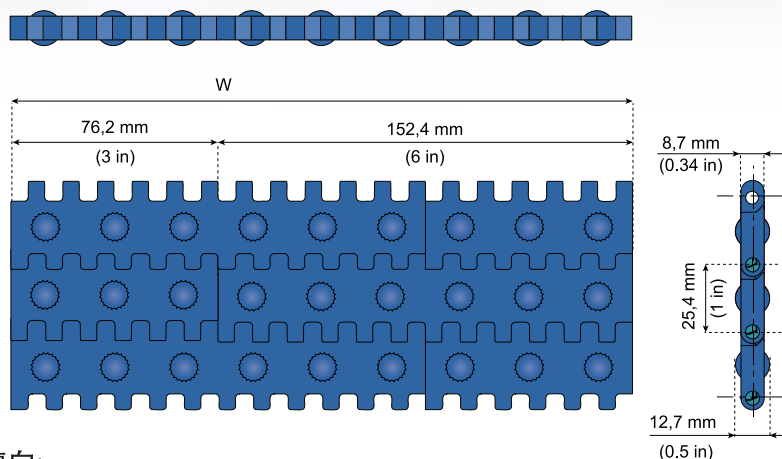

輸送物定位：
 噴印/貼標籤/條碼掃描

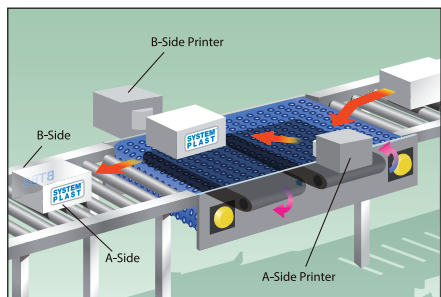

輸送物轉向：
 疊棧/整列/包裝

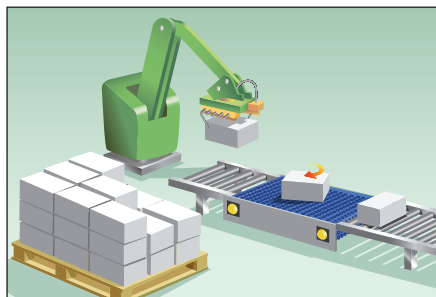

輸送物排出：
 檢出設備 ex 金屬檢出機
 量測設備 ex 秤重設備

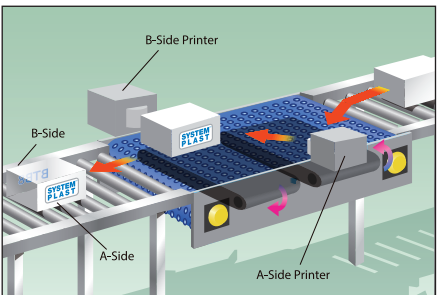

自動倉儲應用：
 物流中心/產線分道/分揀系統

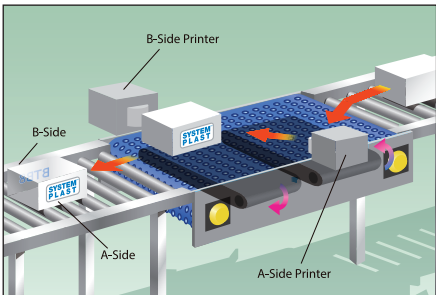

AGV應用：
 升降設備/無人搬運車設備

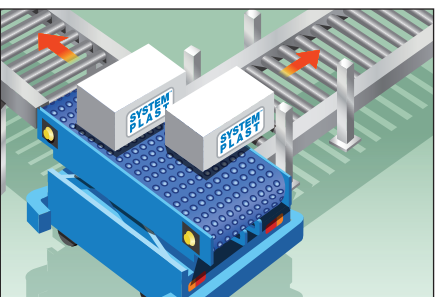

空間節省：
 無空間設置彎曲路徑時

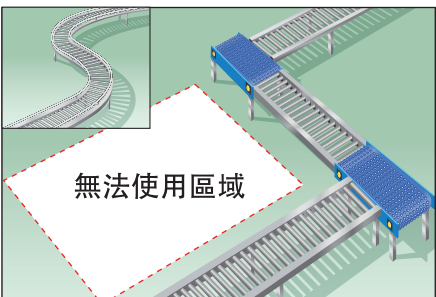

寬度		產品描述
mm	in	
76	3.00	LFB2253RTC-K300
152	6.00	LFB2253RTC-K600
229	9.00	LFB2253RTC-K900
305	12.00	LFB2253RTC-K1200
381	15.00	LFB2253RTC-K1500
457	18.00	LFB2253RTC-K1800
533	21.00	LFB2253RTC-K2100
610	24.00	LFB2253RTC-K2400
686	27.00	LFB2253RTC-K2700
762	30.00	LFB2253RTC-K3000
838	33.00	LFB2253RTC-K3300
914	36.00	LFB2253RTC-K3600
991	39.00	LFB2253RTC-K3900
1067	42.00	LFB2253RTC-K4200
1143	45.00	LFB2253RTC-K4500
1219	48.00	LFB2253RTC-K4800
1295	51.00	LFB2253RTC-K5100
1372	54.00	LFB2253RTC-K5400
1448	57.00	LFB2253RTC-K5700
1524	60.00	LFB2253RTC-K6000
1600	63.00	LFB2253RTC-K6300
1676	66.00	LFB2253RTC-K6600
1753	69.00	LFB2253RTC-K6900
1829	72.00	LFB2253RTC-K7200
1905	75.00	LFB2253RTC-K7500
1981	78.00	LFB2253RTC-K7800
2057	81.00	LFB2253RTC-K8100
2134	84.00	LFB2253RTC-K8400
2210	87.00	LFB2253RTC-K8700
2286	90.00	LFB2253RTC-K9000
2362	93.00	LFB2253RTC-K9300
2438	96.00	LFB2253RTC-K9600
2515	99.00	LFB2253RTC-K9900
2590	102.00	LFB2253RTC-K10200
2666	105.00	LFB2253RTC-K10500
2743	108.00	LFB2253RTC-K10800
2819	111.00	LFB2253RTC-K11100

30395a

www.SystemPlastSmartGuide.com

主動輪和從動輪

用於 2250 - 2253FT - 2253RTC

Notes:

• 單鏈槽鏈輪可在最大溫差30° C的條件下用於寬度在680mm以內的網帶。

• 對於更寬的網帶或更大的溫差，應使用方形孔或者帶雙鏈槽圓孔的鏈輪。

驅動鏈輪專門設計在軸心上緊密配合用。

如需訂購能夠在軸心上自由滑動的單鏈槽鏈輪，只需在現有產品料號中添加字母“P” (=plus)即可。例如：**2250-14R30M-DPS**

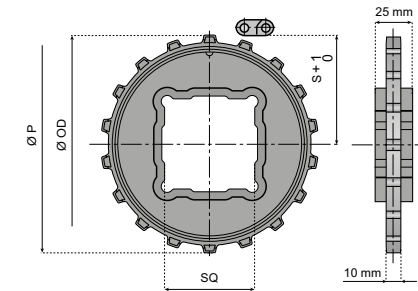

適用於2253RTC和2253FT系列網帶，同時與2250系列網帶相容



Information about this product is only available on our Smart Guide® website.

2253RTC - 2253FT - 2250系列網帶鏈輪

Z	ITEM DESCRIPTION	
	∅ 40X40	∅ 60X60
12	2253-12S40M-D	-
15	2253-15S40M-D	2253-15S60M-D
18	2253-18S40M-D	2253-18S60M-D

材質:增強型聚醯胺(灰色)

Z	Ø OD mm	Ø P mm	S mm
12	98	98,14	44,0
14	113	114,18	52,0
15	122	122,2	56,7
16	129	130,2	60,0
18	145	146,27	68,5
20	162	162,37	76,5



See also the sprockets and idler wheels:

30395b

30395c



See belts 1" Pitch (25,4 mm):

30300a

New design **30995a**

Features:

- 創新對拆式設計。
- 高機械強度。
- 對拆式:快速且更換方便。
- 防呆設計。
- 優良的耐磨與耐腐蝕性。
- 可回收。

2250系列網帶鏈輪

Z	ITEM DESCRIPTION		
	∅ 30	∅ 35	∅ 40
14	2250-14R30M-DS	2250-14R35M-DS	2250-14R40M-DS
16	2250-16R30M-DS	2250-16R35M-DS	2250-16R40M-DS
18	2250-18R30M-DS	2250-18R35M-DS	2250-18R40M-DS
20	2250-20R30M-DS	2250-20R35M-DS	2250-20R40M-DS
塑膠射出驅動鏈輪-對拆式			
14	2250-14R30M-RS	2250-14R35M-RS	2250-14R40M-RS
16	2250-16R30M-RS	2250-16R35M-RS	2250-16R40M-RS
18	2250-18R30M-RS	2250-18R35M-RS	2250-18R40M-RS
20	2250-20R30M-RS	2250-20R35M-RS	2250-20R40M-RS
塑膠射出驅動鏈輪(方形孔)-浮動			
Z	∅ 30X30	-	∅ 40X40
14	2250-14S30M-DS	-	-
16	2250-16S30M-DS	-	2250-16S40M-DS
18	2250-18S30M-DS	-	2250-18S40M-DS
20	2250-20S30M-DS	-	2250-20S40M-DS

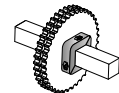
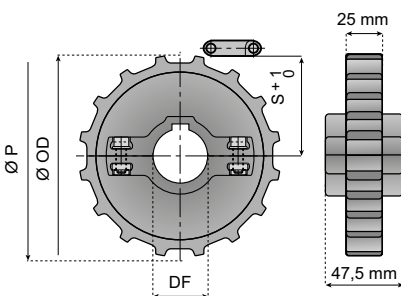

固定環，請至

54630a

2250系列網帶專用!

材質: 增強型聚醯胺(黑色), 螺絲為不鏽鋼、螺母為鍍鎳黃銅。
注意: 這些鏈輪不適用於網帶類型2253RT-2253FT